

FILTER LIFE 0-15 PSID, MAXIMUM DIFFERENTIAL 25PSID  
 #25 FLOW RANGE 1-25 GPM, MAXIMUM FLOW RATE 30 GPM  
 #50 FLOW RANGE 1-50 GPM, MAXIMUM FLOW RATE 65 GPM  
 SRL-(BAG SIZE)-(I/O SIZE)-(MATERIAL)-(OPTION)

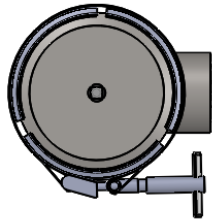

SRL-50  
 #50 SIZE(4X20)

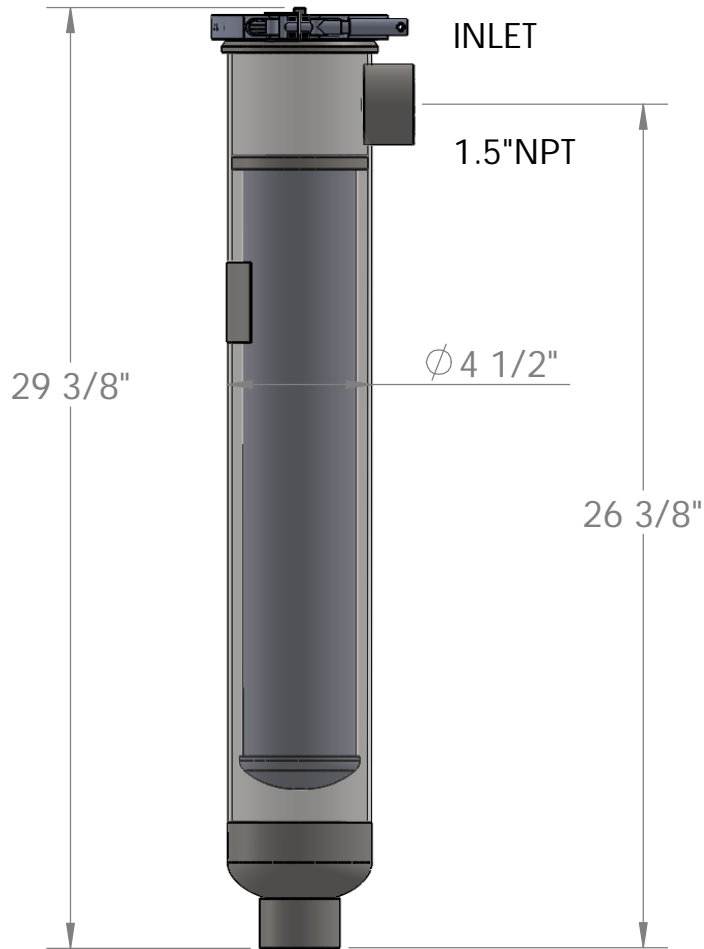

SHIPPING WEIGHT 10LBS #25, 17LBS #50  
 6"X6"X36"

SRL-25  
 #25 SIZE(4X10)

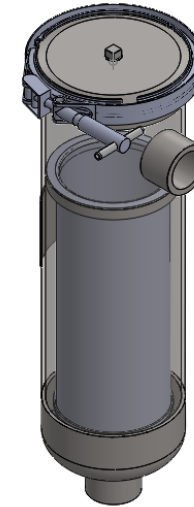
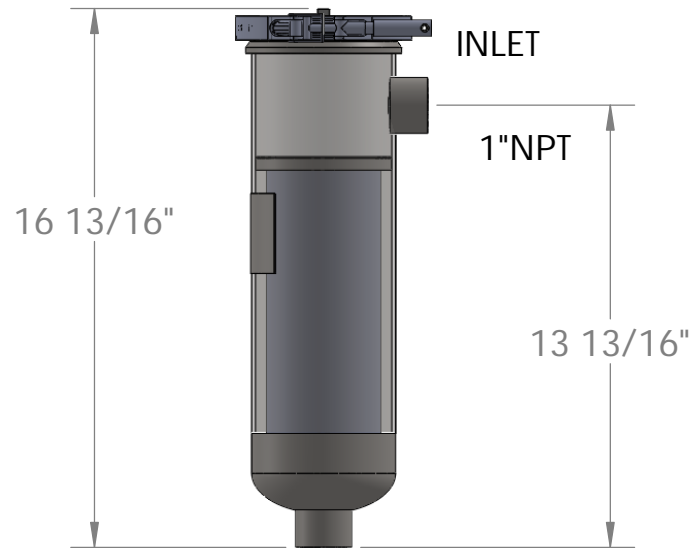

STANDARD EQUIPMENT:  
 -PERFORATED SS BASKET  
 -BAND CLAMP COVER  
 -BUNA ORING COVER SEAL  
 -MAWP 100 PSI @ 200F  
 -UP TO 2" I/O CONNECTIONS

Prod Order: -	M.A.W.P. <u>100</u> P.S.I at <u>200</u> F
Customer: -	M.D.M.T. <u>-20</u> F at <u>100</u> P.S.I
Cust. P.O.: -	Hydrostatic Test at <u>130</u> P.S.I
Cust. Tag: -	
Est. Weight <u>XX</u> Lbs. Full <u>XX</u> Lbs.	MFG. Serial# <u>TBD</u>

THIS REPRODUCTION IS A PROPRIETARY DESIGN AND CONFIDENTIAL INFORMATION OF UF STRAINRITE INC. AND IS LOANED SUBJECT TO THE CONDITIONS THAT: (1) IT SHALL BE USED OR CAUSED TO BE USED FOR RECORD AND REFERENCE PURPOSES; (2) IT SHALL NOT BE USED OR CAUSED TO BE USED FOR PROCUREMENT IN ANY WAY PREJUDICIAL TO UF STRAINRITE INC. INTERESTS; (3) IT SHALL NOT BE REPRODUCED OR COPIED IN WHOLE OR IN PART; AND (4) IT SHALL NOT BE DISCLOSED AS GENERAL OR SPECIFIC INFORMATION WITHOUT EXPRESSED CONSENT IN WRITING SIGNED BY AN AUTHORIZED REPRESENTATIVE OF UF STRAINRITE INC

UNLESS OTHERWISE SPECIFIED  
 DIMENSIONS ARE IN INCHES  
 TOLERANCES:  
 ANGLES  $\pm 10^\circ$  FRACTION:  $\pm 1/8$   
 .XXX =  $\pm XX$  .XX =  $\pm 0.0625$

MATERIAL  
 316-304-CS

Drawn By:	DCB
Date:	1/22/2019
WPS:	S1S R2
Drawing:	REF.

**SRL-BC-REFERENCE**

STRAINRITE INC  
 65 First Flight Drive  
 Auburn Maine  
 (207) 777-3100